

1

Fully remove the refill tab.

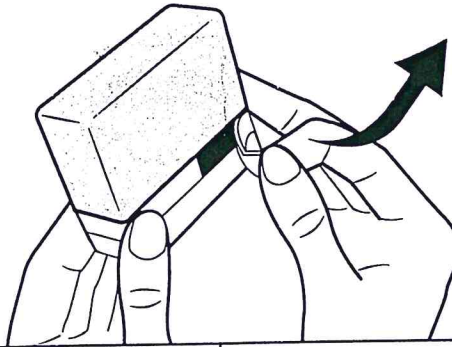

2

Position the refill, top down, in the PerfectClean refill housing.

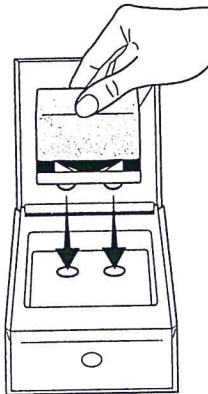

3

Push the refill gradually and horizontally up to the stops to pierce the caps. Wait for all the liquid to run out.

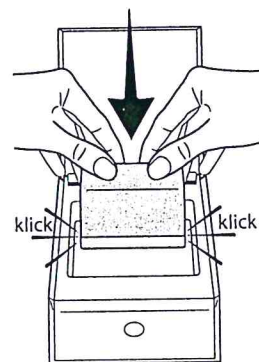

Special precautions for use

Only use the refill when the PerfectClean indicates it.
Completely fill the refill at each fill.

Cleaning the filter (before each refill)

1. Place the PerfectClean® on its front face (the side with the start button).
2. Remove the filter cap by pivoting it to the left to the "I" position.
4. Clean the filter thanks to hot water or a cleaning tablet (in a glass)
3. Fit the cap in the "I" position and turn it to the right to the "II" position.

Emptying (to travel or transport)

1. Place the PerfectClean® on its front face (the side with the start button).
2. Remove the filter cap by pivoting it to the left to the "I" position.
3. Put the PerfectClean® flat over a sink to drain the remaining liquid.
4. Refit the cap in the "I" position and then turn it to the right to the "II" position.